

**IDC - punch down blocks**

**Technical Spec.:**

Electrical:

1. Voltage Rating: 250VDC
2. Current Rating: 1,5A
3. Contact Resistance: 10 mΩ max.
4. Insulation Resistance: 1.000MΩ min. @ 500VDC
5. Dielectric Strength: 1.000 VAC, 60Hz, 1min.

Mechanical:

1. Housing Material: PC UL94V-0
2. Contact Material: Phosphor Bronze with Silver or tin plating.
3. Wire: AWG 24-26

Environmental:

1. Storage Temperature: -20°C to +80°C and humidity up to 95%
2. Operational 0°C to 70°C

**PDB40**

4 pole IDC terminal block with contacts 0° - straight

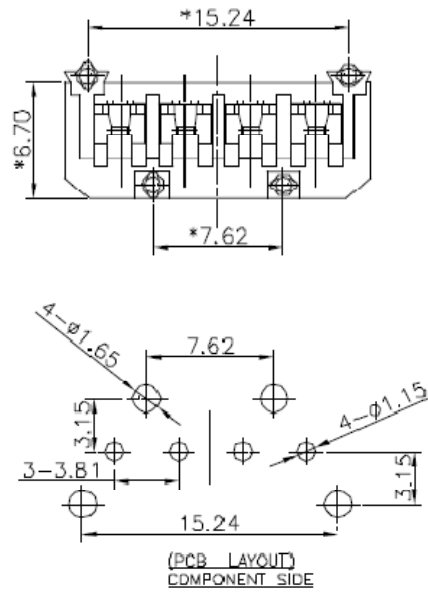
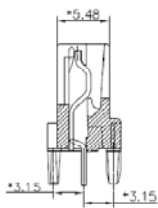

**PDB80**

8 pole IDC terminal block with contacts 0° - straight

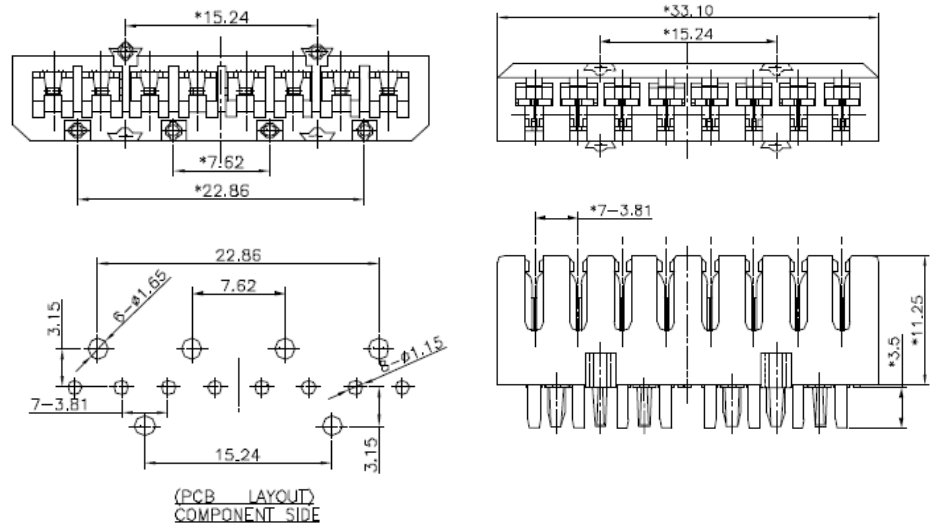
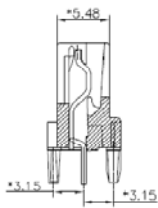
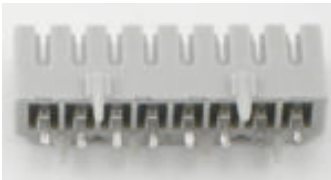

**PDB4A**

4 pole IDC terminal block with contacts 45°

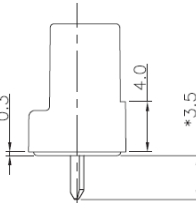
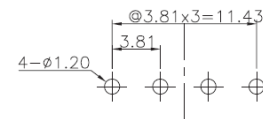
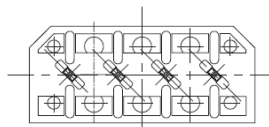
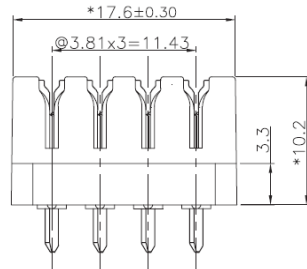

PC Board Layout  
Component Side Shown

**PDB8A**

8 pole IDC terminal block with contacts 45°

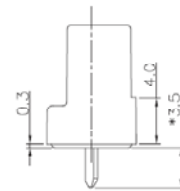
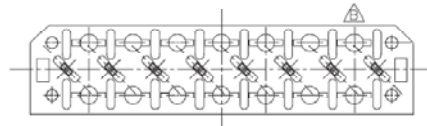
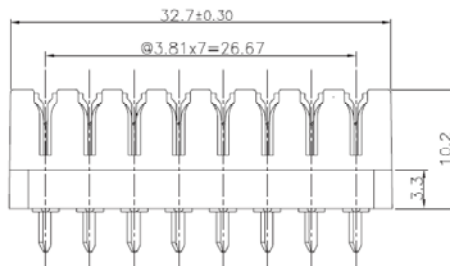

PC Board Layout  
Component Side Shown

**PDB2S**

2 pole stackable IDC

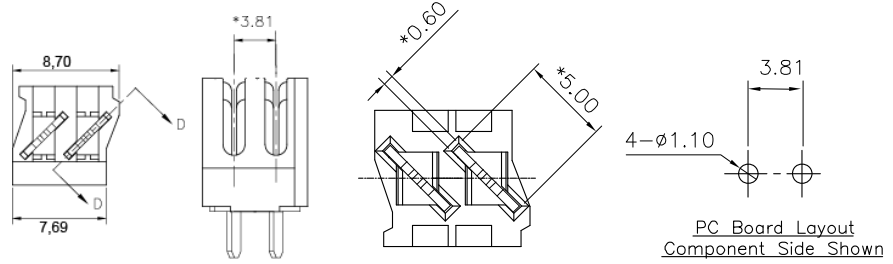

**PDB4S**

4 pole stackable IDC

